



SUNREEF 70 SAIL  
ROLEENO



# SUNREEF 70 SAIL ROLEENO

The layout is a galley down 4 cabin version with modern, very minimalistic interior design. The port side hull features an impressive master suite with a king size bed, a spacious bathroom in the forward section with a large shower cabin and a separate toilet. One double guest cabin is located on the aft. Starboard hull comprises two double guest cabins and a fully-equipped galley on the aft. There are 2 crew cabins in the forepeaks, accessible only from the wet deck, increasing privacy.

## General Information:

Builder: Sunreef Yachts  
Year: 2013  
Flag: Red Ensign  
Material: GRP  
Category A: 16 passengers

Length overall - 21,80 m / 71,5'  
Waterline length: 20,90 m 68,5'  
Breadth overall: 10,10 m 33,1'  
Lightship displacement : 31 T / 69440 lbs  
Draft minimum: 1.9 m / 6,2'  
Mast length: 31,5 m / 103,3'

Fully battened main sail: 155 m<sup>2</sup>  
Genoa: 95 m<sup>2</sup>  
Solent: 50 m<sup>2</sup>  
Main engines: Yanmar 2 x 240 HP  
Fuel capacity: 2 x 3000 l

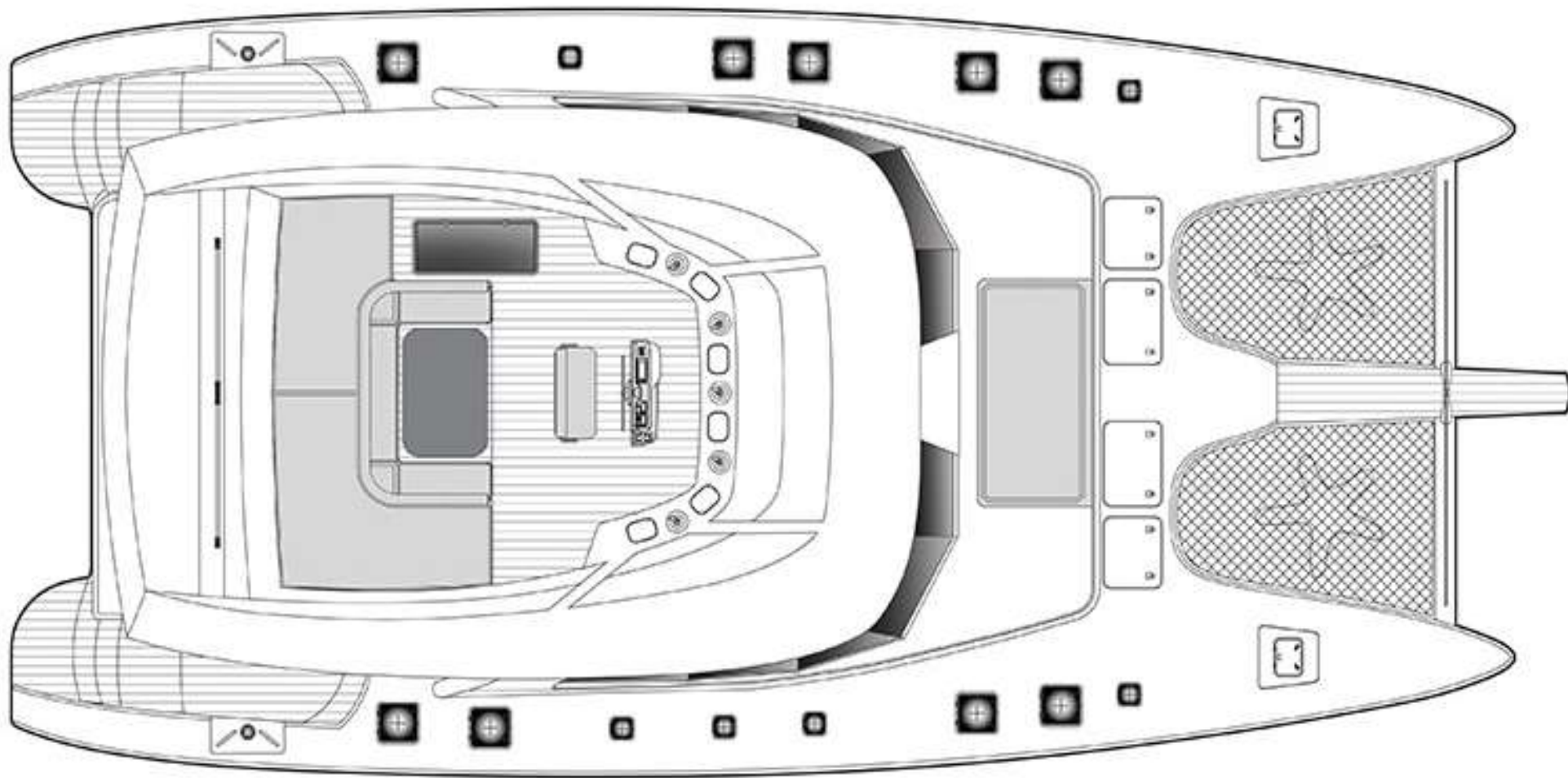

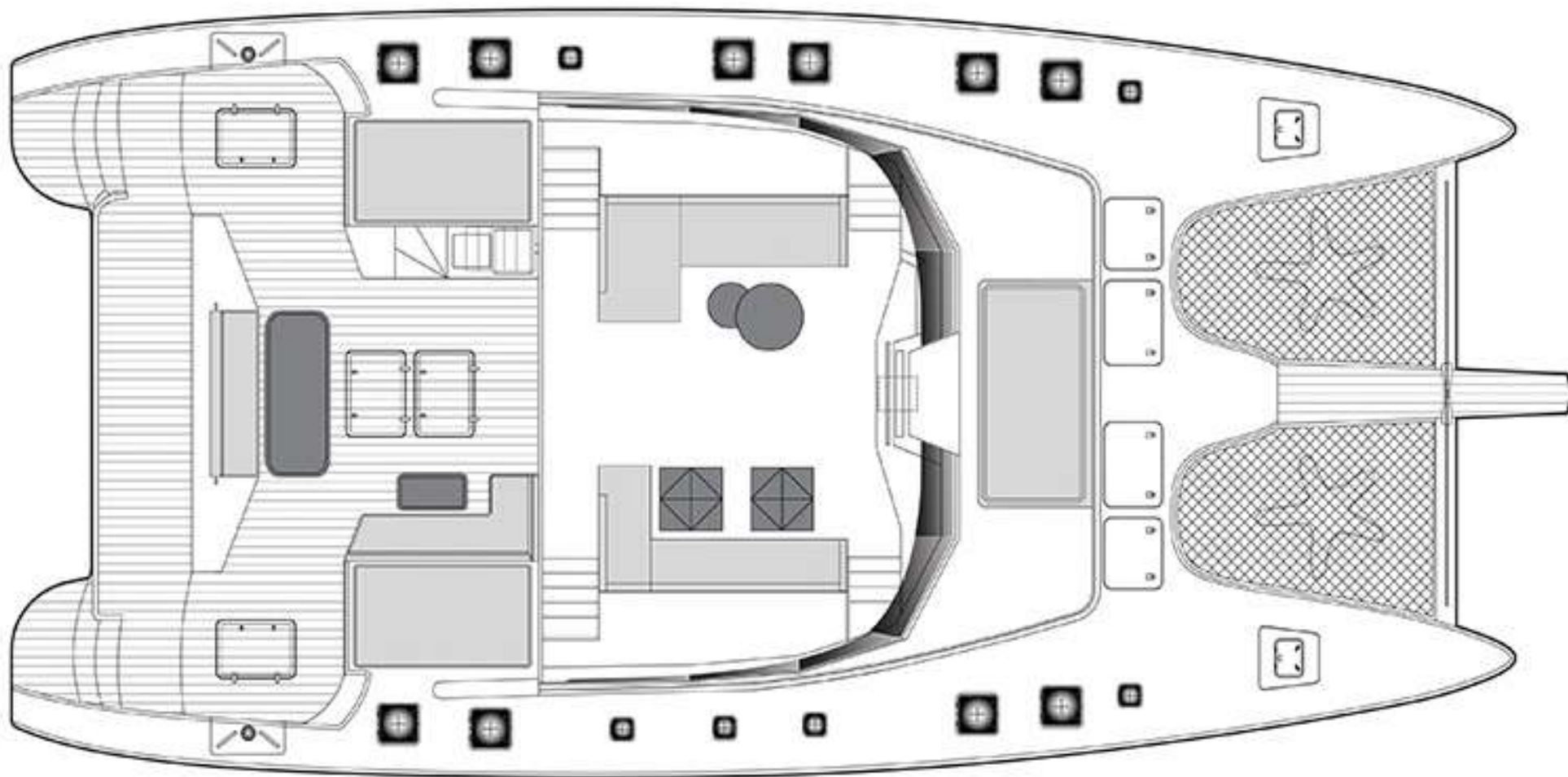

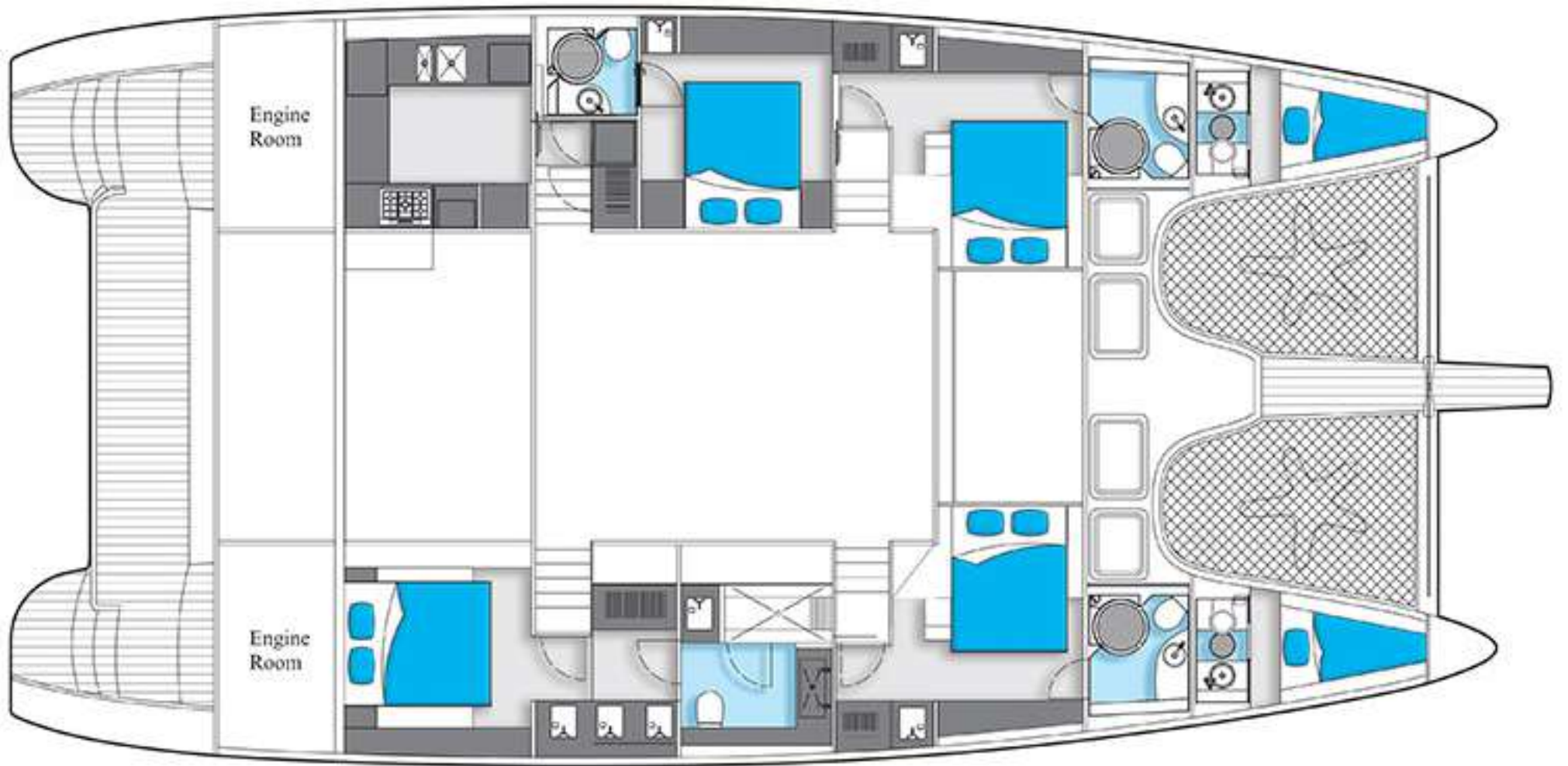

## CONSTRUCTION

- Hulls, deck, flybridge and all structural bulkheads constructed of glass/vynilester sandwich laminate with carbon reinforcement by infusion process
- Rudders constructed of a moulded glass/vynilester
- Rudder stocks are in aluminium alloy
- Extended re-enforced longitudinal beam
- Catwalk fitted on the forward beam
- Aft platform

## MECHANICS

- Stainless steel shafts
- 2 three-bladed folding propellers STW/Brotons
- 2 Engine speed controls (one at the navigation table and one on the flybridge) Type B
- 1 electric pump + 1 manual for fuel tanks
- Lights in the engine rooms
- 2 complete engines 240 HP (Yanmar)
- 2 electric bow thrusters (Side Power)
  
- Extension of the fuel tanks to 2 x 3000 L

## STEERING SYSTEM

- Rudders constructed of a moulded sandwich lamination glass/ vynilester
- Self-aligning lower and top bearings
- Carbon steering wheel
- Hydraulic steering system
  
- 2 emergency tillers

## RIGGING / DECK GEAR

- Carbon mast with incorporated LEDs (27 m)
- Carbon boom
- Plastic protections on the shrouds
- Lazy jack
- Fully battened main sail made of Dacron 1st choice, cross cut, 2 reefs
- Genoa double pleated made of Dacron 1st choice
- Mast steps up to boom
- Solent 1st choice double pleated Dacron
- Complete gear for solent
- Bow pulpits with integrated teak seats
- Lewmar port lights
- 1 swim ladder on the skirts
- Winches
- Blocks and jammers
- Genoa manual furler
- Deck light
- Exterior lighting: Rotating deck search-light, 2 additional lights for the flybridge with separate switch, LEDs in skirts' stairs, cockpit and flybridge
- Electric lifting system for the dinghy with extendable arms and remote controller
- Hatch at the top of the stairway between cockpit and flybridge
- 2 outputs freshwater (mast + cockpit)
- Main sail electric winch (Harken)
- 2 primary electric winches (Harken)
- Bimini on the flybridge (stainless steel)
- Hydraulic gangway – 3 parts (Opacmare)
- 8 extra waterproof speakers (Bose)
- Stain steel gas BBQ
- 2 aft capstans for mooring



## NAVIGATION

- Compass (size 135mm)
- Chronometer and barometer
- Raymarine E-series electronic pack:
- 9" display in saloon nav. station and multifunctional
- 12,1" display with build in GPS
- radar 4kW 24" HD
- autopilot with gyrocompass and 2 pilot control heads
- 4 universal displays for speed, depth and wind display
- VHF with DSC function (dual station)
- AIS transceiver
- Navtex (Furuno)
- Portable VHF (Raymarine)
- Fog horn

## GENERAL COMFORT ON BOARD

- Electrically recessed Skyscreen blinds in the saloon and owners cabin (manual in the guest cabins)
- Manually concealed Skyscreen with anti-mosquito screens on cabin ceiling hatches
- Air conditioning installation in the saloon, galley and cabins: 120000 BTU (Webasto)
- Full-size back cushions on the seat behind cockpit table
- Full-size back cushions on the flybridge
- Stainless steel sliding door instead of aluminium (upgrade)
- Fitted forepeak with bed, toilet, shower and sink

Electrical appliances:

- Refrigerator for drinks in the cockpit

## HI-FI AND APPLIANCES:

- Widescreen LCD TV 40" in the saloon
- Denon home cinema system in saloon with Dali speakers  
cockpit: 2 waterproof speakers  
flybridge: 2 waterproof speakers
- Satellite TV antenna
- Kitchen appliances package (Siemens & Gorenje):
  - Dishwasher
  - Stainless steel microwave with optional oven and grill function
  - Electric oven
  - Gas stove
  - Cooker hood
  - Freezer
  - Refrigerator in kitchen

## INTERIOR FINISHING

- Furniture and all interior panels made of individually selected wood of category A with polyurethane varnish
- All upholstery and cushions made of synthetic fabric
- Hull, deck and flybridge in white gelcoat
- Front saloon windows finished with black hatch frames and dark plexi panel
- Side of hulls painted in colored gelcoat light colors (grey RAL 7004)
- Deck and superstructure grey RAL 7015
- Cockpit, flybridge and skirts covered with teak
- Deck covered with teak and installed flush hatches





## ELECTRICAL & LIGHTS SYSTEMS

- AC-230V: Main panel extension, 2 chargers (Victron TG 24V/100A), Inverter (Victron Phoenix 24V/5000A), two 230V sockets in cabins (Vimar), additional sockets in saloon and galley
- DC-24V: Main panel extension, Battery monitoring, 12 house batteries (Oddyssey PC1800FT 24V/1200Ah), starting batteries (PC2150)
- 2 alternators 24V/70A (Victron Balmar)
- 2 x Generator 27kVA 230 Volts, 50 Hertz (Cummins Onan)
- Navylec system for lights, controls and D/C system, including lights for ceiling lights
- Interior lighting with LED lamps
- Navigation lights with LED lamps
- 8 underwater LED lights

## PLUMBING

- Fresh water : 2 x 800 l equipped with level indicators, 2 pressurized pumps, 2 water heaters of 80L
- Black water : 2 x 137 L each tanks with discharge system, 2 electric pumps with automatic discharge equipped with 3 way valves (*discharge in the sea or holding tanks*)
- 4 electrical bilge pumps
- 2 manual bilge pumps
- 2 hand showers on deck
- Watermaker 220 L/h – 220V (Sea Recovery)
- 2 x 170 L grey water tanks with electric pumps of additional extraction and piping installation
- Electric toilets 24V in bathrooms with fresh water flush (*silence version*)

## SAFETY EQUIPMENT

- Automatic fire extinguishing system in the engine rooms
- Complete safety equipment pack : 2 life rafts for 8 people, rescue equipment (16 lifejackets, first aid kit, flares, lifebuoy, signalling mirror, wooden plugs, flag set, fog horn), Set of fire extinguishers
- Adaptation to the MCA regulations for category 2

## MOORINGS & TOOLS

- Windlass 3000 W 24V (Quick)
- Anchor 60 kg FOB + 130 m galvanised chain (diameter 13mm) 130m łańcucha
- Additional anchor 20kg + 20m galvanised chain (diameter 10mm)



























Swell Yachting

[www.swellyachting.com](http://www.swellyachting.com)

Golan Levi  
[golan@swellyachting.com](mailto:golan@swellyachting.com)  
T: +442081441113  
T: +972543000933

Anna Nowotarska  
[anna@swellyachting.com](mailto:anna@swellyachting.com)  
+48514222349