

SUNREEF 62 SAIL



BLUE I



SUNREEF 62 SAIL BLUE I

Blue I features a unique modern cleancut design, with a combination of furniture painted in white lacquer and cream alcantara. Her charter version arrangement is adapted to owner use. She has a spacious modified saloon layout with a very comfortable lounge area, which can be transformed into regular sofa, ottoman and coffee table. The boat is in excellent condition as she has been only privately used and well maintained by professional crew.



General Information:

Builder: Sunreef Yachts

Year: 2008

Flag: Cayman Islands

Material: GRP

Category A: 12 passengers

Lenght overall: 18.9 m / 62.00 Ft

Breadth overall: 9.27 m / 30.40 Ft

Lightship displacement : 27T

Draft minimum: 1.65 m / 5.40 Ft

Mast lenght: 24.99 m / 82.00 Ft

Main engines: Yanmar 2 x 125 HP

Fuel capacity: 2 x 900 l

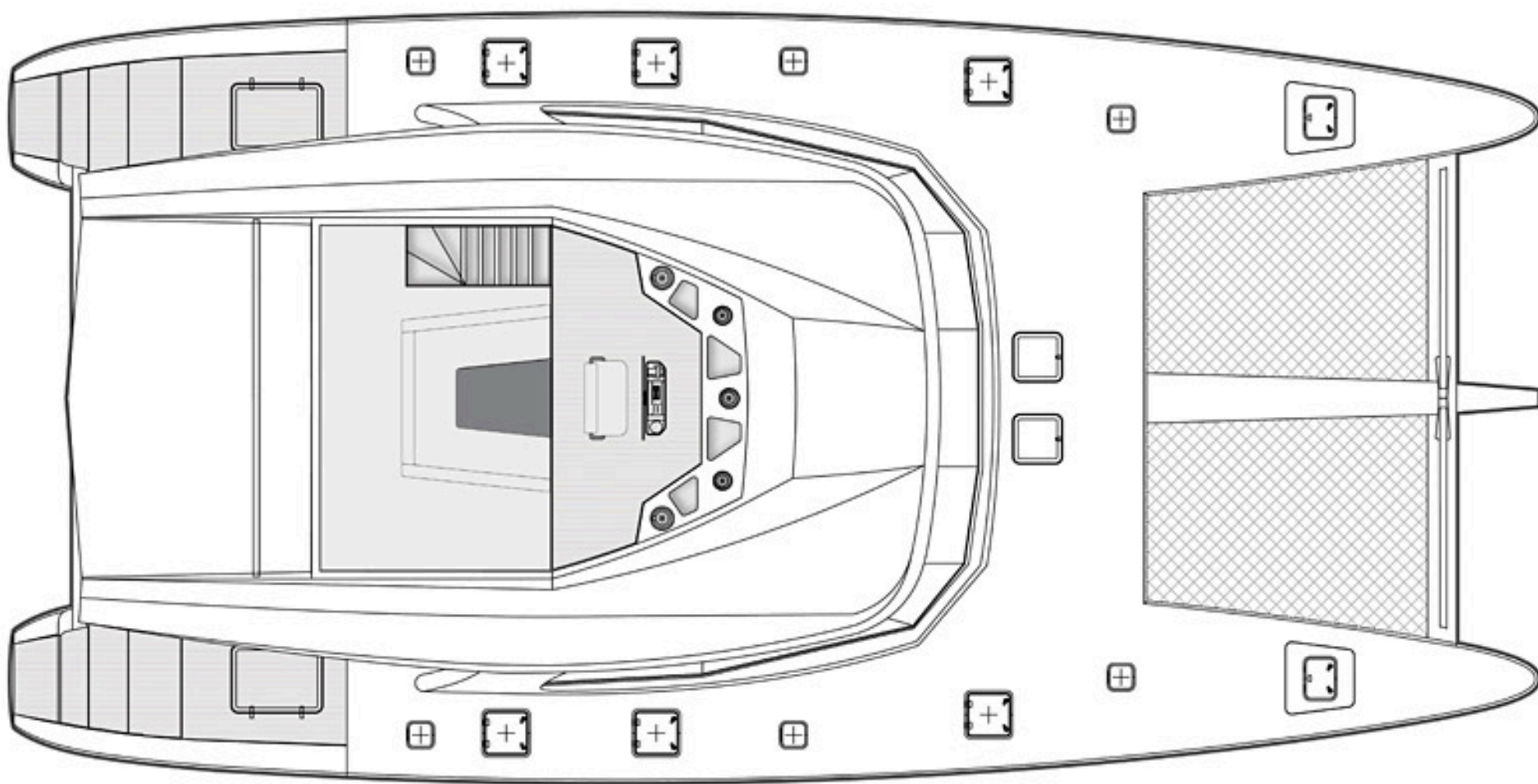

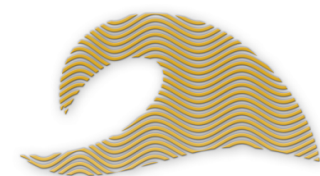
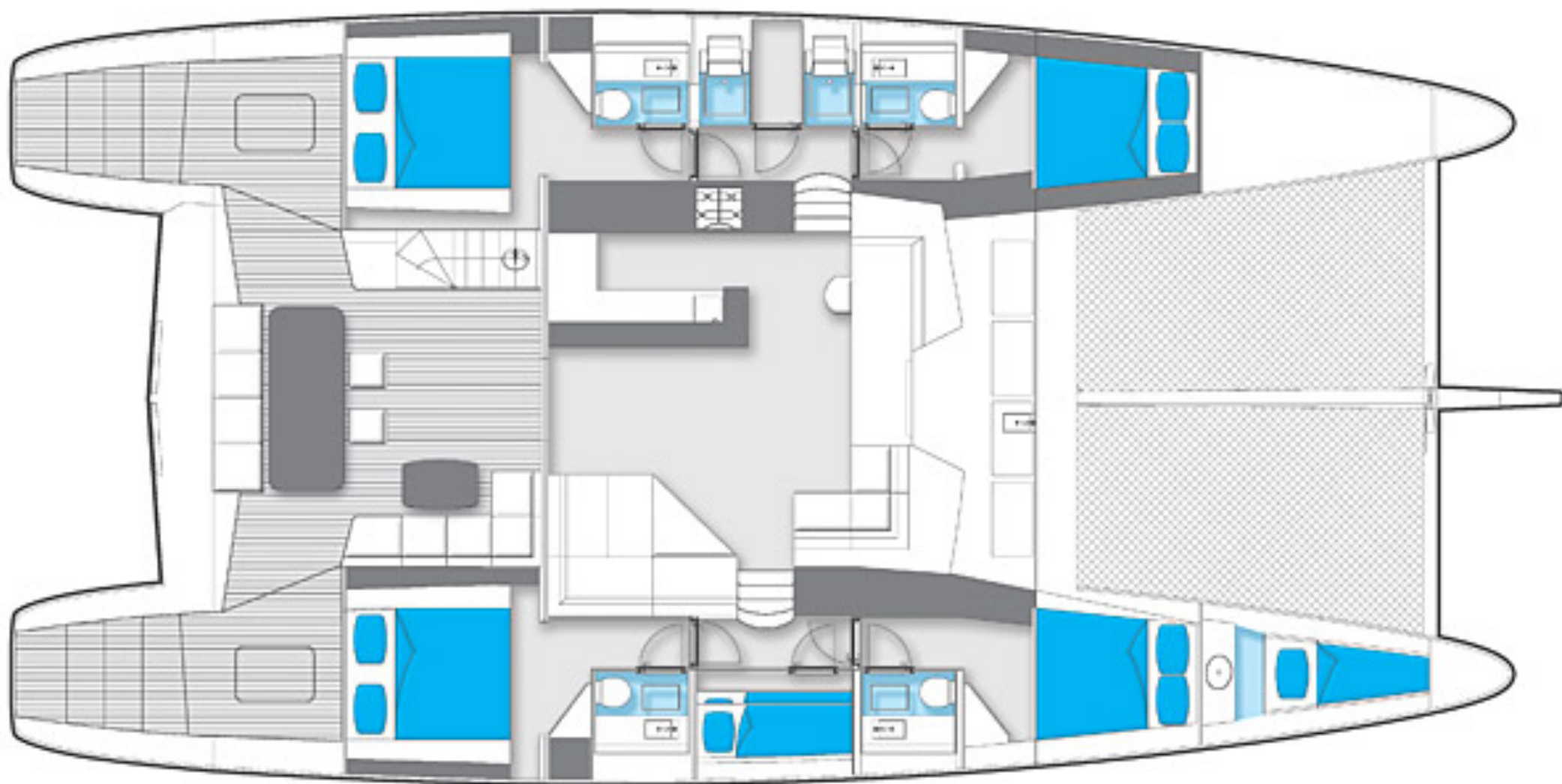

Swell Yachting

CONSTRUCTION

- Hulls, deck, flybridge and all structural bulkheads constructed of glass/vynilester and polyester sandwich laminate
- Rudders constructed of a moulded sandwich glass/vynilester. Rudders stocks in aluminium alloy
- Aft platform
- Extended reinforced longitudinal beam
- Electric lifting system for the dinghy with extendable arms and remote controller

RIGGING / DECK GEAR

- Carbon mast with incorporated LEDs and carbon boom
- Fully battened mainsail hydranet tri-radial cut
- Solent hydranet
- Hydranet genoa, mixed Dacron/spectra instead of Dacron
- Gennaker polyester
- Complete gear for Solent
- Complete gear for Gennaker
- Main sail electric winch
- primary electric winches
- Bimini on the flybridge (stainless steel)
- Hydraulic gangway
- Rotating deck search-light
- 2 additional lights for the flybridge + separate switch
- 2 fresh water outlets (mast step + cockpit)
- 2 waterproof speakers in the flybridge
- 2 waterproof speakers in the cockpit
- LEDs on the skirts, cockpit and flybridge

MECHANICS

- 2 Engines 125 HP (Yanmar)
- Pair of 3 bladed folding propellers for 110 HP engines (needs option 3.2)
- Consumption estimation system
- 2 electric bow thrusters
- Extension of fuel tanks to 2 x 900L
- Two extra engine instruments at the navigation table

NAVIGATION

- Raymarine E-Series
- Fishfinder
- Navigation display duplicate on the saloon TV
- Smart Controller (wireless autopilot controller with instrument repetitor)
- External camera with color and night vision



GENERAL COMFORT ON BOARD

Generalities

- Electrically recessed Skyscreen blinds in the saloon (manual in the cabins)
- Manually concealed skyscreen on cabin ceiling hatches
- Stainless steel sliding entrance door (upgrade)
- Fitted forepeak (bed only)
- Fitted forepeak with toilet, shower and sink (without bed)
- Separate shower in bathroom

Electrical appliance

- Air conditioning 60 000 BTU
- Washing machine / dryer with complete installation
- Dishwasher with complete installation
- Stainless steel microwave with oven and grill function
- Cooker hood
- Ice maker
- Wine cooler for 32 bottles

Leisure

- Widescreen LCD TV 40" saloon
- Hi-Fi Pack 1: Harman/Kardon (saloon)
- LCD TV 20" + DVD/CD player
- Satellite TV antenna 9.3.5 Safe
- Full-size back cushions on the seat behind cockpit table
- Full-size back cushions on the flybridge

INTERIOR FINISHING

- Teak toe rails along deck sides
- Cockpit flybridge and skirts floor covered with teak
- Deck covered with teak and installed flush hatches
- Front saloon windows finished with black hatch frames and dark plexi panel
- Modern design
- Charter version adapted to owner use
- Unique combination of furniture painted in white lacquer and cream alcantara
- Modified saloon layout with a spacious and very comfortable lounge area, which can be transformed into regular sofa, ottoman and coffee table



ELECTRICAL & LIGHTS SYSTEMS

- Additional upgrade of electric kit
- 110V shore connection kit
- 2 alternators
- Generator 16 KVA
- Lights on dimmer
- Underwater lights Xenon

PLUMBING

- Watermaker 220 l/h - 220V
- Electric toilet in bathroom (price per toilet)

SAFETY EQUIPMENT

- Complete rescue equipment with life-rafts for 12 persons
- Automatic fire extinguishing system in the engine rooms
- Gas detection system + alarm
- EPIRB
- Man overboard system
- Additional lifetag for man overboard system

MOORINGS & TOOLS

- Mooring kit (8 fenders + 4 mooring ropes)
- Anchor 40 kg CQR instead of FOB
- Shroud cutter

























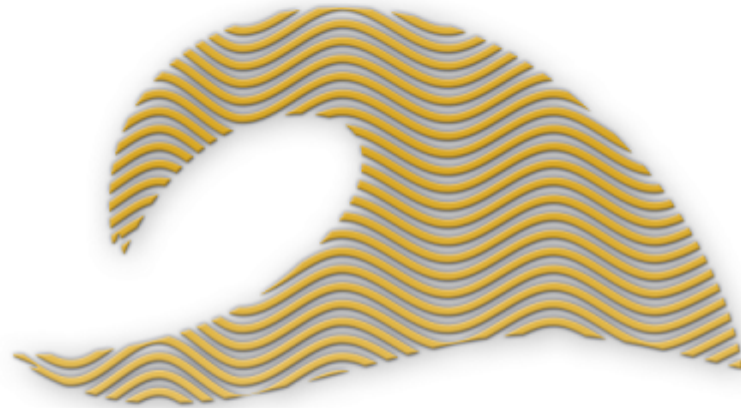

Swell Yachting

www.swellyachting.com

Golan Levi
golan@swellyachting.com
T: +442081441113
T: +972543000933

Anna Nowotarska
anna@swellyachting.com
+48514222349